

ZONE WIRELESS RECEIVER

Complete Setup Guide

完整设置指南

完整設定指南

설치 가이드

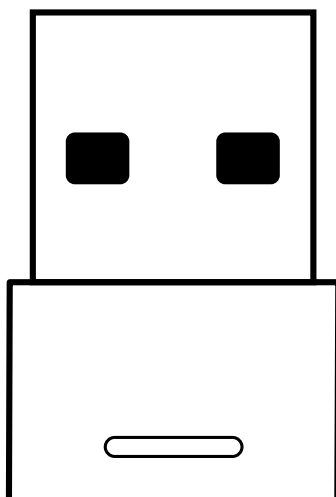

CONTENTS

English	3	繁體中文	9
简体中文	6	한국어	13

KNOW YOUR PRODUCT

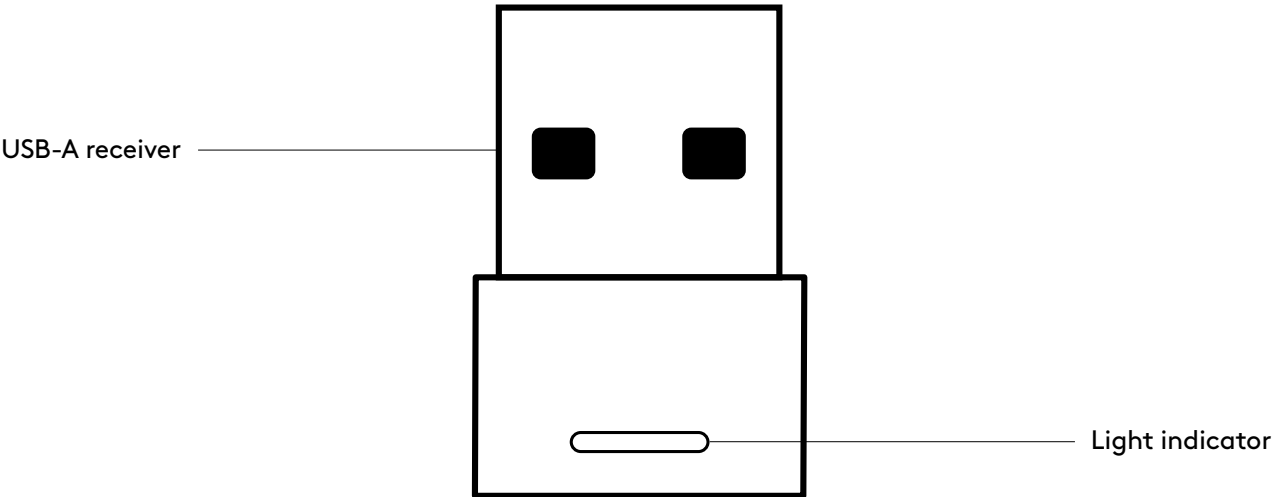

WHAT'S IN THE BOX

USB-A receiver

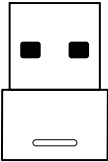

CONNECTING THE RECEIVER TO THE HEADSET

1. **a.** Insert the receiver into the computer USB-A port.
b. Insert the receiver into the USB-C adapter. Then insert the adapter into the computer USB-C port.

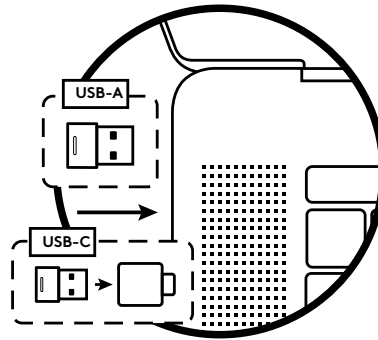

2. Install and open Logi Tune Desktop. Download it from www.logitech.com/logitune

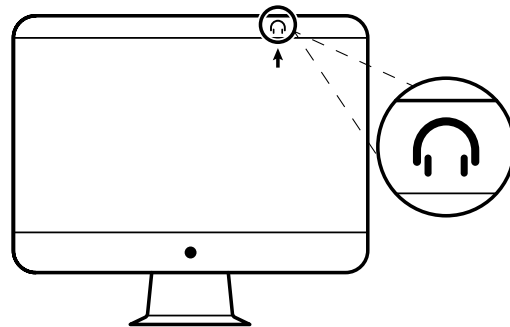

3. Logi Tune Desktop will confirm that a new receiver is found. Enter pairing mode on headset by pressing the power button for 3 seconds. Click **Continue**.

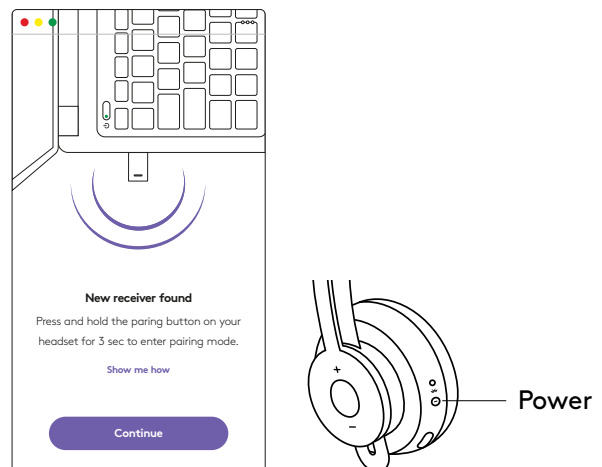

4. If pairing mode is successful, light indicators on the receiver and headset will flash white.

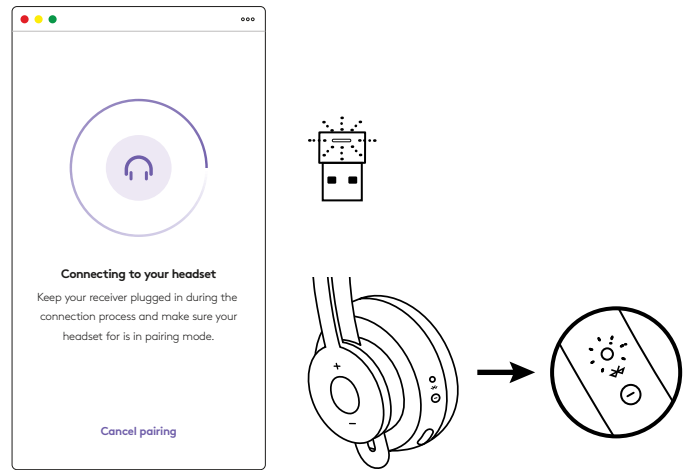

5. Once you see this screen, the receiver is now paired with the headset. Light indicators on the receiver and headset will turn solid white.

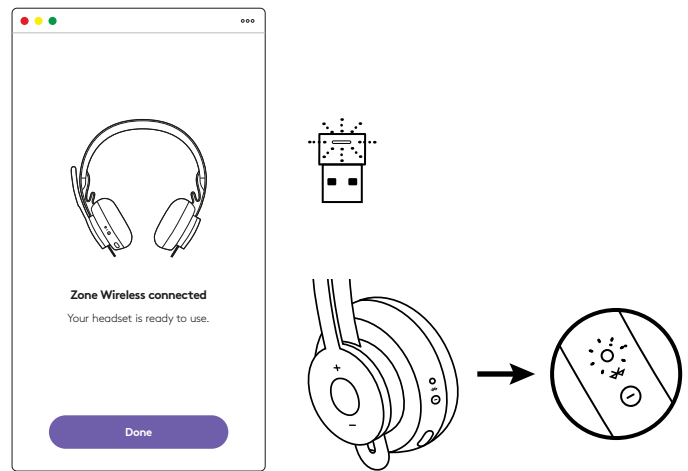

DIMENSIONS

RECEIVER:

Height x Width x Depth: 21.5 mm x 13.6 mm x 6 mm

www.logitech.com/support/zone-wireless-receiver

了解您的产品

USB-A 接收器

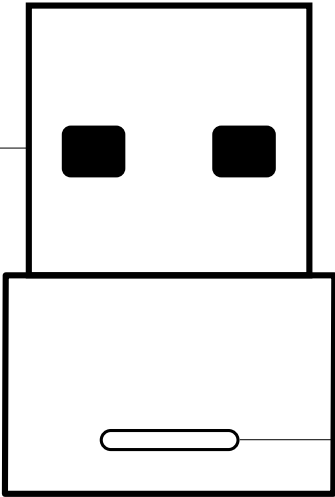

指示灯

包装内容

USB-A 接收器

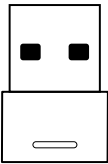

将接收器与耳机麦克风进行连接

1. **a.** 将接收器插入电脑的 USB-A 端口。
b 将接收器插入 USB-C 适配器。将适配器插入电脑的 USB-C 端口。

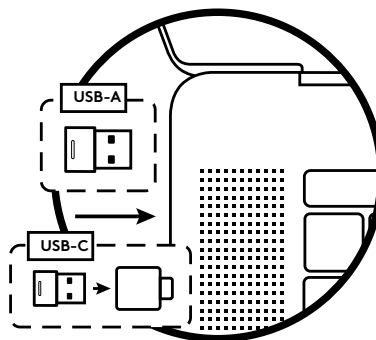

2. 安装并启动 Logi Tune 桌面版。下载请访问 www.logitech.com/logitune。

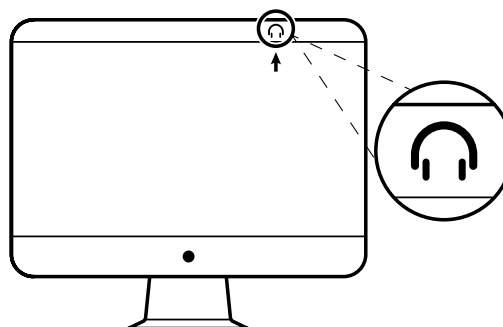

3. Logi Tune 桌面版将确认找到新的接收器。按住电源按钮 3 秒，进入耳机麦克风的配对模式。单击继续。

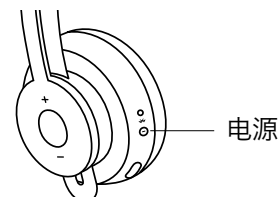
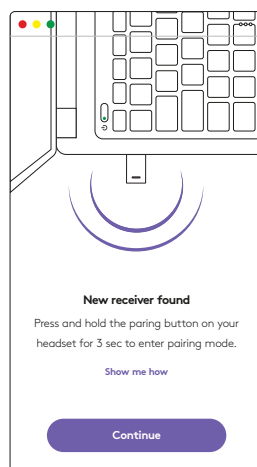

4. 如果配对模式成功，接收器和耳机麦克风的指示灯将闪烁白色。

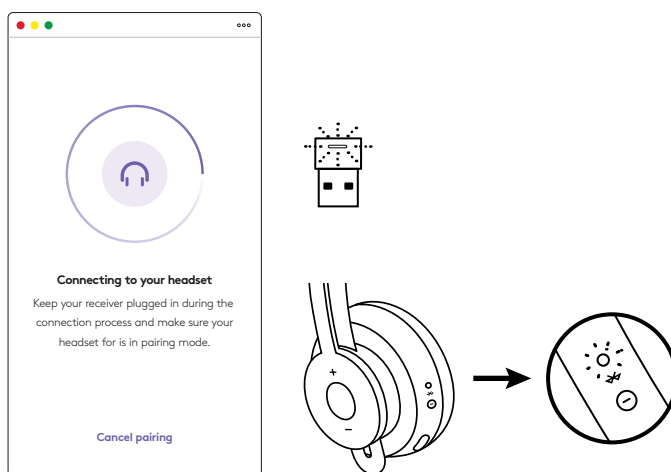

5. 看到此屏幕后，接收器即已与耳机麦克风配对。接收器和耳机麦克风指示灯将常亮白色。

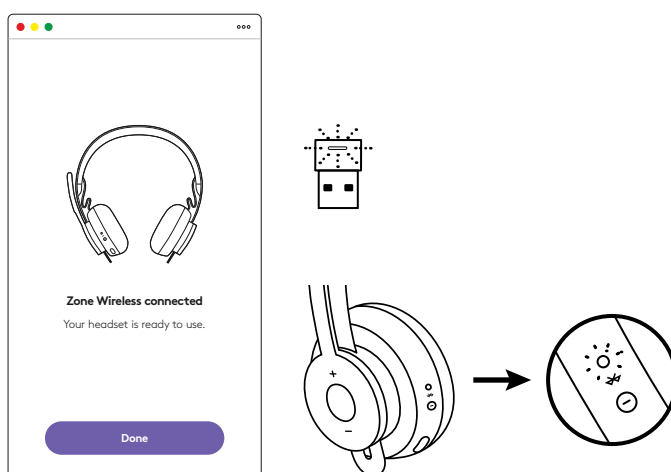

规格

接收器：

高 x 宽 x 深： 约21.5 毫米 x 约13.6 毫米 x 约6 毫米

www.logitech.com/support/zone-wireless-receiver

瞭解您的產品

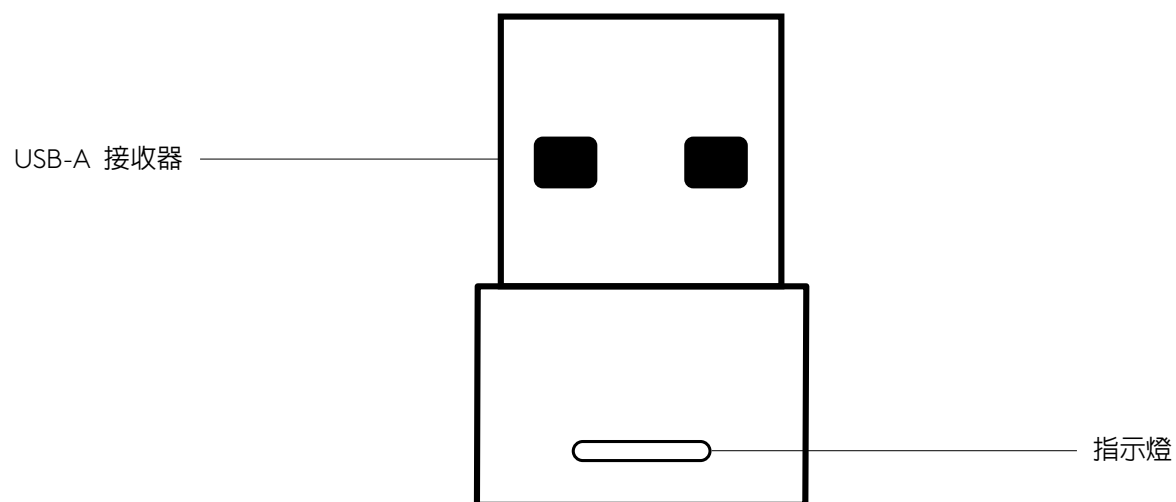

包裝內容

USB-A 接收器

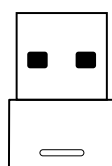

將接收器連線到耳機麥克風

1. **a.** 將接收器插入到電腦的 USB-A 連接埠。
b. 將接收器插入到 USB-C 轉接器。然後將轉接器插入到電腦的 USB-C 連接埠。

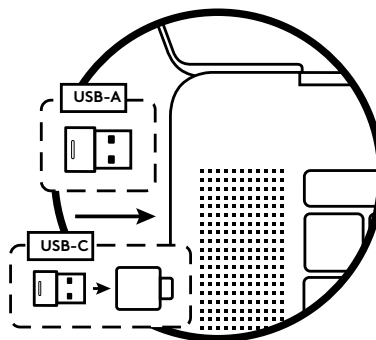

2. 安裝並開啓 Logi Tune Desktop。此軟體可從 www.logitech.com/logitune 下載

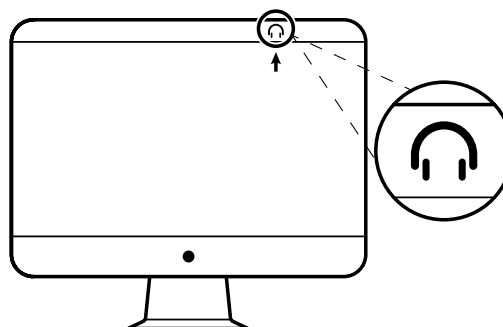

3. Logi Tune Desktop 會確認找到新接收器。按住電源按鈕 3 秒以在耳機麥克風上進入配對模式。按一下繼續。

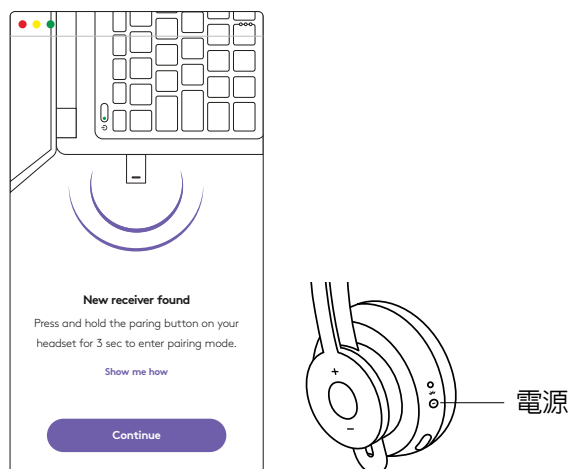

4. 如果成功進入配對模式，接收器和耳機麥克風上的指示燈會閃爍白燈。

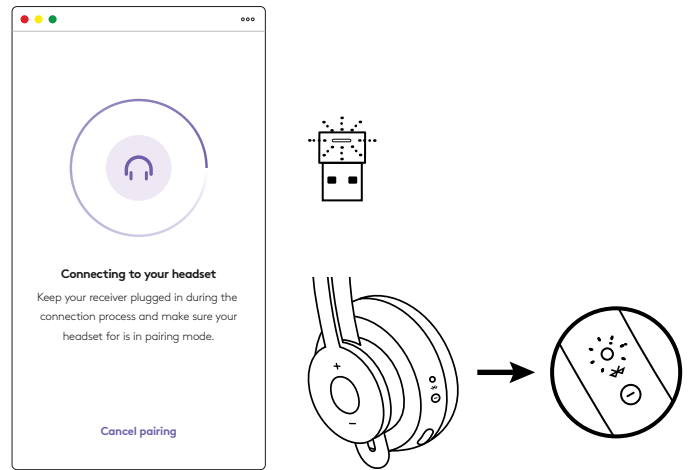

5. 當看到此畫面時，接收器即已和耳機麥克風配對。接收器和耳機麥克風上的指示燈會轉為亮起穩定白燈。

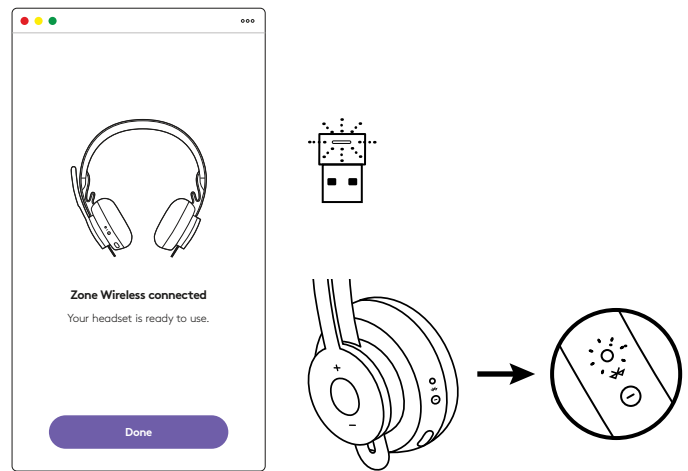

尺寸

接收器：

高 x 寬 x 深：21.5 公釐 x 13.6 公釐 x 6 公釐

www.logitech.com/support/zone-wireless-receiver

제품 설명

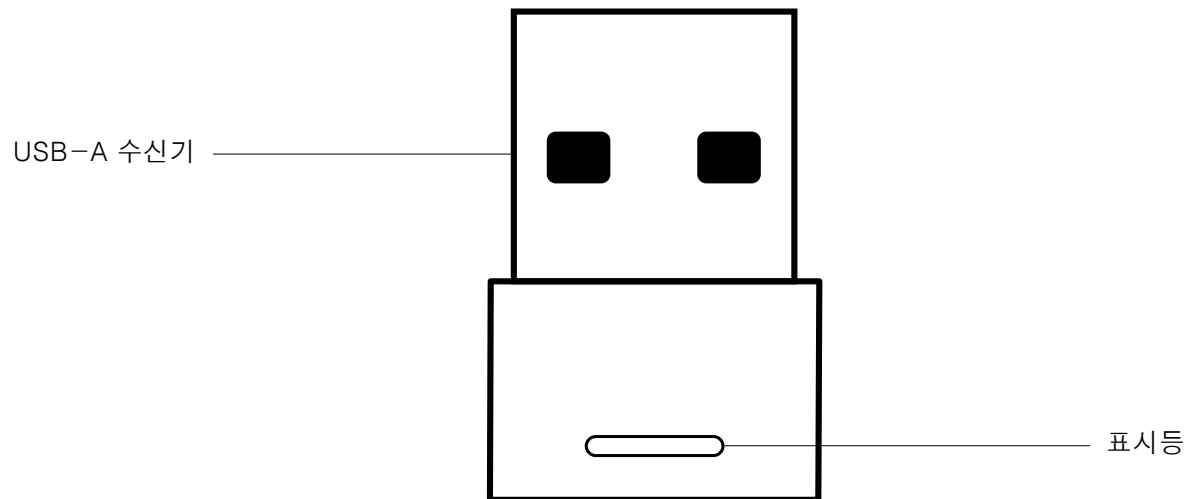

박스 내용물

USB-A 수신기

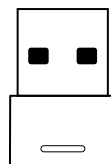

수신기와 헤드셋 연결

1. **a.** 수신기를 컴퓨터 USB-A 포트에 연결합니다.
b. USB-C 수신기를 USB-C 어댑터에 삽입합니다.
그런 다음 컴퓨터 USB-C 포트에 어댑터를 삽입합니다.

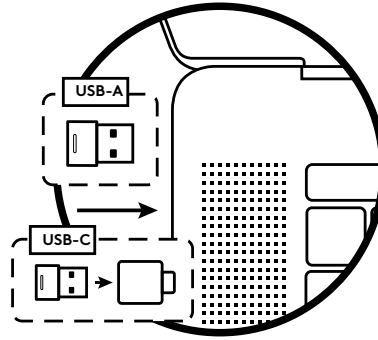

2. Logi Tune 데스크탑을 설치하고 엽니다.
www.logitech.com/logitune에서 다운로드

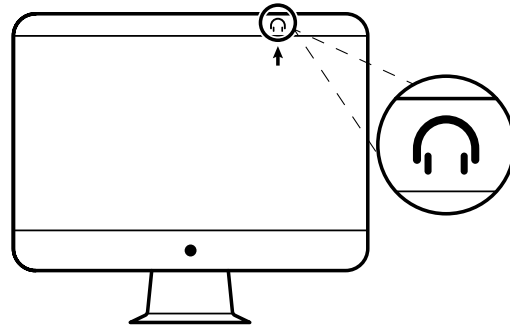

3. Logi Tune 데스크탑에서 새 수신기를 감지하였음을 확인합니다. 전원 버튼을 3초 동안 눌러 헤드셋 페어링 모드로 들어갑니다. **계속**을 클릭합니다.

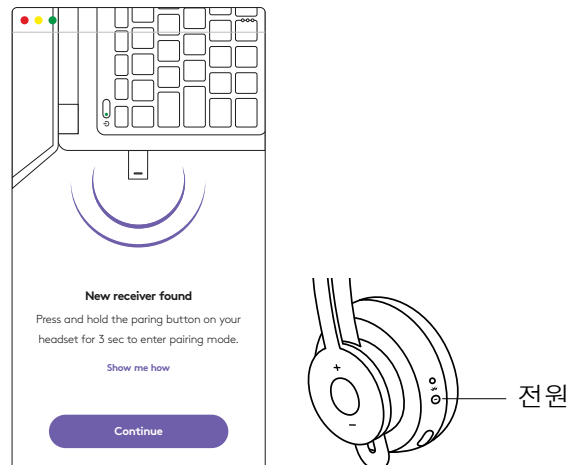

4. 페어링 모드가 성공하면 수신기와 헤드셋의 표시등이 흰색으로 깜박입니다.

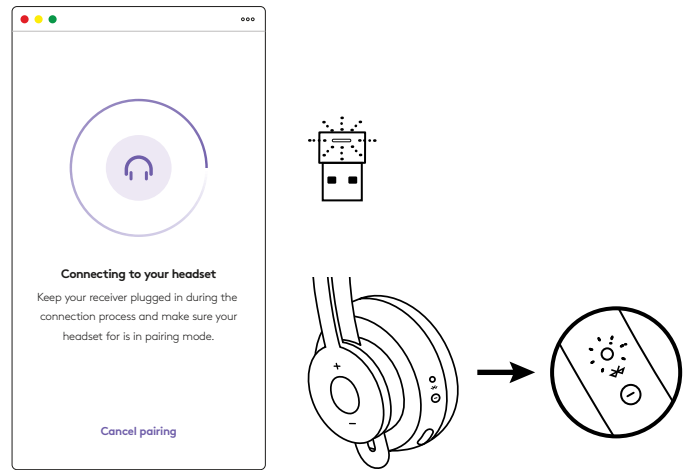

5. 이 화면이 표시되면 수신기가 헤드셋과 페어링된 것입니다. 수신기와 헤드셋의 표시등은 흰색으로 유지됩니다.

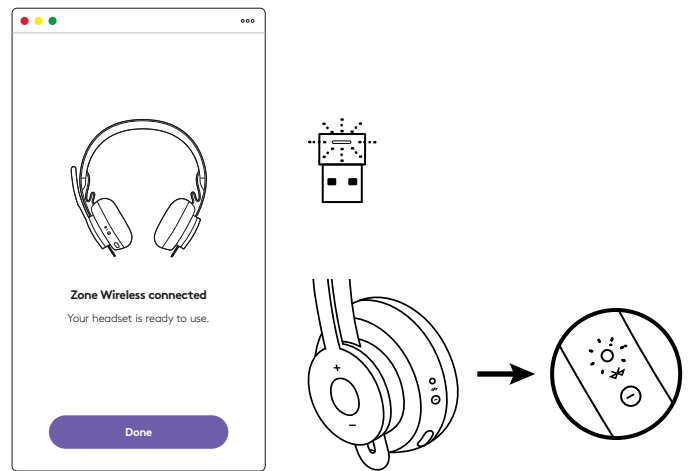

규격

수신기:

높이 x 너비 x 깊이: 21.5 mm x 13.6 mm x 6 mm

www.logitech.com/support/zone-wireless-receiver